

SOLACE

the evolution of auto-connectivity™

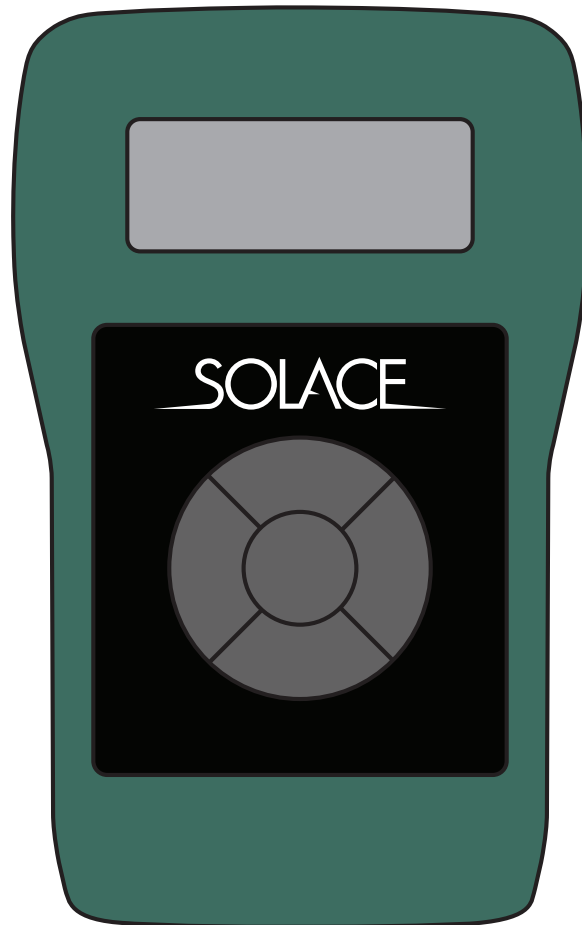

SOLACE HANDHELD PROGRAMMER (SHHP-SP)

INSTRUCTIONS

Revision 2.01

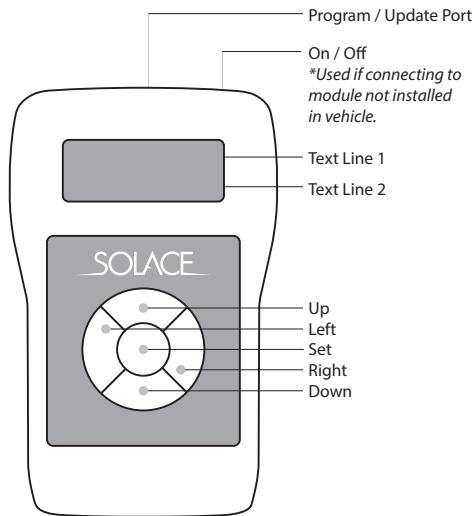

Connecting SHHP to Module:

- 1 - Connect cable from program port on SHHP to Antenna port on remote starter module. (SHHP will get power from module)
- 2 - Press right button on SHHP to cycle through Info Screen's and enter programming menu's. (if "comm. error" appears check connection and repeat steps)
- 3 - Press left button once to save and disconnect.

1st Screen

SOLACE HHP-X v10 — SHHP Version
 IC4 SW : v 52 — Firmware Pre-Loaded

2nd Screen

Solace Main Unit — Module Connected
 Ver. SW:51 Hw:03 — Firmware Version / Hardware Version

3rd Screen

Unit:Sw:45 Hw:01 — Firmware Version / Hardware Version
 Int. Sw:51 Hw:03 — Firmware Version / Hardware Version Pre-Loaded

Programming Options:

- 1 - Connect to module.
- 2 - Use *Up* and *Down* buttons to cycle through menus. Press *Right* button on desired menu to enter.
- 3 - Use *Up* and *Down* buttons to cycle through sub-menus or options. Press *Right* button on desired menu to enter.
- 4 - Use *Up* and *Down* buttons to cycle through sub-menus or options. Press *Right* button on desired option to enter.
- 5 - Use *Up* and *Down* buttons to cycle programmable options. Press *Set* button to program feature.
- 6 - Press *Left* button to go back to Step 2.
- 7 - Press *Left* button once to save and disconnect.

Menu Descriptions:

- Menu 1 - Lock and data features
- Menu 2 - Start features
- Menu 3 - Alarm features
- Menu 4 - Programmable outputs
- Overload Fault - Dedicated Driver Protection Circuit Events
- Start Fault - Stored remote start faults
- Alarm Event - Stored alarm trigger zones
- Start Event - Remote start origin source
- Temp Calibrate - Temperature sensor calibration for units without thermistor (S Series)
- Reset/Flash - Reset all options / Flash firmware to remote start module

Updating Programmer:

- 1 - Download Solace Bootloader from www.SolaceRemoteStarters.com
- 2 - Connect SPCC (Solace USB cable) to computer.
- 3 - Open Solace Bootloader.
- 4 - Choose COM port and click connect.
- 5 - Connect USB to SHHP with update cable supplied with programmer.
- 6 - Click Browse and locate "SOLACE_HHP_Vxx_x-SERIES_Vxx.sol" file to load.
- 7 - Click "Write Flash" button on bootloader (If error appears disconnect SHHP and go back to step 4)
- 8 - Wait till "WRITE OK" is displayed in progress window. Click "Release/Run"
- 9 - Disconnect SHHP from USB.

Your SHHP is now updated.

***There is 1 firmware each for iSeries and sSeries, choose which firmware you wish to have on SHHP.*